



DAF-225Ex

FRONT-MOUNTED MULCHERS

Achieve
High Productivity
and **Low Costs**

in land clearing and vegetation control.

ideal for intensive brushcutting applications mounted on wheeled or tracked skid steers or other dedicated units that are designed for use with front-mounted attachments.



Industrial Land Clearing



Forest Fire Prevention



Road Development and Maintenance



Pipelines Development and Maintenance



Transmission Lines Development and Maintenance

DAF-225Ex

FRONT-MOUNTED MULCHERS



Motor

Variable displacement, axial-piston motors that minimize overheating and improve re-acceleration.



Drive

Industrial cogged belt drive system that prevents slippage and reduces effort applied to bearings compared with V-belts, for longer bearing life.



Rings

Protective rings that limit the size of the bites and considerably reduce risks of breakage on the knife holders.

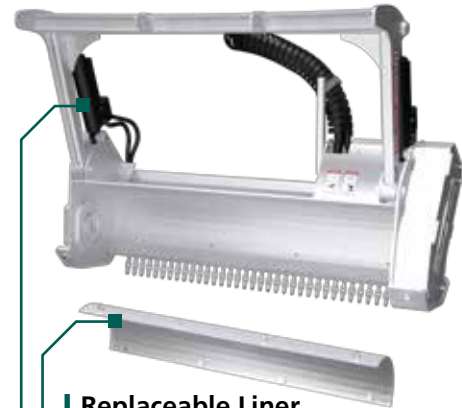

Replaceable Liner

With the high speeds and forces involved in industrial mulching, even the hardest steel frame is subject to wear and tear. This easy-to-replace, bolt-in wear liner extends the lifetime of the unit by protecting the frame.

Hydraulic pushbar option

Especially useful when working in older growth as a secure way to direct where big trees will fall when cutting them down

SPECIFICATIONS	DAF-225Ex
Approximate Min. Carrier Power [kW (hp)]	150 (200)
Cutting Width [cm (in)]	216 (85)
Cutting Distance from Ground Level [cm (in)]	1 (0.4)
Number of Blades on Rotor	31
Optimal Target Material Diameter [cm (in)]	60 (24)
Exterior Width [cm (in)]	258 (102)
Exterior Height (with Pushbar) [cm (in)]	148 (58)
Exterior Width (with Pushbar) [cm (in)]	130 (51)
Exterior Height (without Pushbar) [cm (in)]	96 (38)
Exterior Width (without Pushbar) [cm (in)]	83 (33)
Rotor Diameter [cm (in)]	51 (20)
Approximate Typical Weight [kg (lbs)]	2360 (5200)

HYDRAULIC SYSTEM	DAF-225Ex
Variable Displacement Axial Piston Motor [cc]	2x 115
Required Continuous Flow [L/min (gal/min)]	276 (73)
Max. Operating Pressure [bar (psi)]	240 (3500)
Rotating Speed [rpm]	2500
Pressure Line I.D. [# (in)]	#20 (1.25)
Return Line I.D. [# (in)]	#20 (1.25)
Drain Line I.D. [# (in)]	#16 (1.00)

OPTIONS	DAF-225Ex
Type of Sharpenable Bolt-on Forged Blades	Standard
Hydraulic Pushbar	✓
Bolt-on wear liner	✓

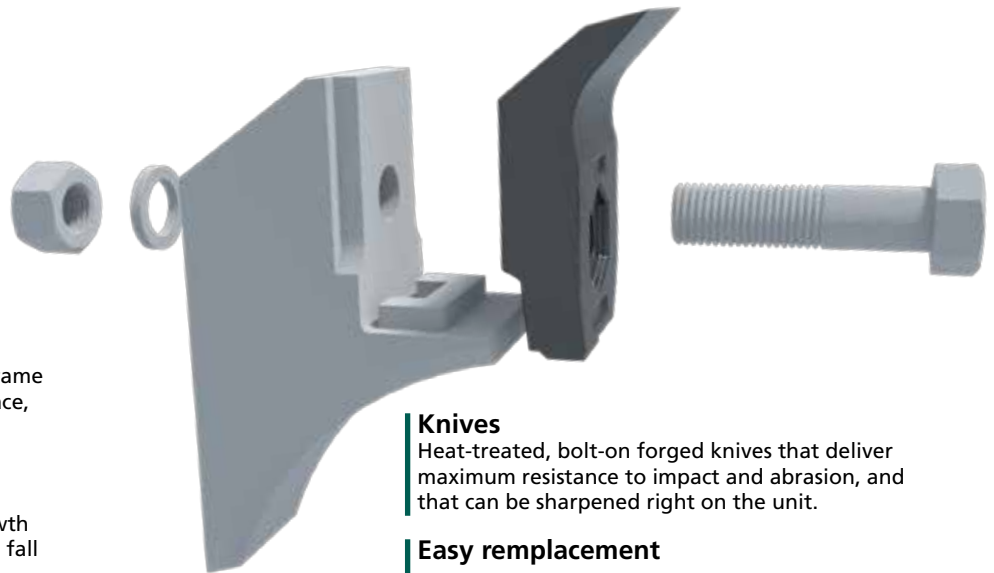

Knives

Heat-treated, bolt-on forged knives that deliver maximum resistance to impact and abrasion, and that can be sharpened right on the unit.

Easy replacement

Easy-to-replace knives: A single nut and bolt holds the knife in place. Replacing worn knives is a very easy.

CONTACT US

Printed in Canada : 2018-02

211 rue Notre-Dame
Roxton Falls QC J0H 1E0
Canada
www.deniscimaf.com

Toll free : 877-279-2300
Phone : 450-548-7007
Fax: 450-548-7008
info@deniscimaf.com

DENIS CIMAFA